

# HEYTHROP PARK

This map is not drawn to scale

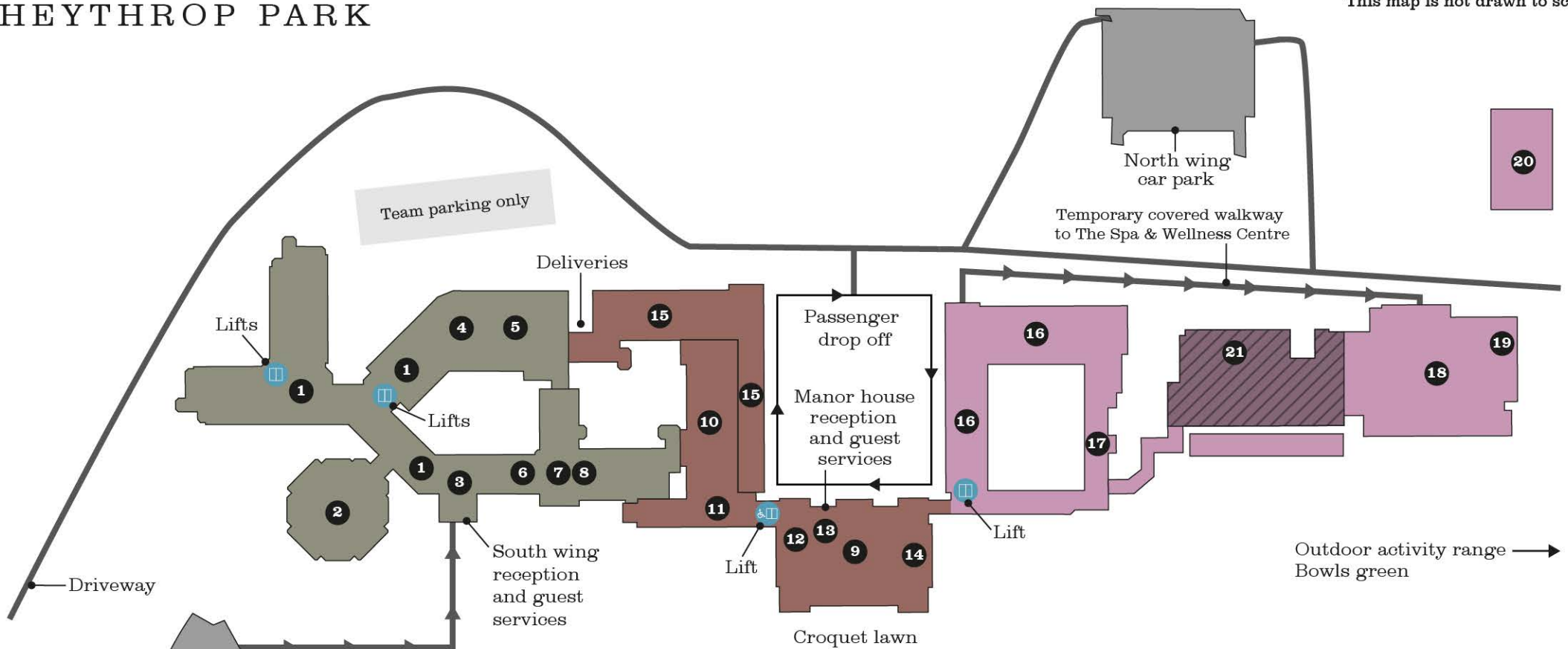

## South wing

- 1 - South wing rooms
- 2 - The Theatre
- 3 - Reception and guest services
- 4 - Late Lounge bar
- 5 - Late Lounge
- 6 - The Snug
- 7 - Brassey Bar
- 8 - The Travelling Duke Pub & Kitchen

## Manor house & wings

- 9 - Manor house rooms
- 10 - Market Kitchen in the Orangery
- 11 - Orangery lounge
- 12 - Brasserie32 in the Manor house
- 13 - Reception and guest services
- 14 - Manor house lounges
- 15 - Manor house wing rooms

## North wing

- 16 - Manor house wing rooms
- 17 - Indoor shooting range
- 18 - Spa & Wellness Club
- 19 - The T Golf & Activities
- 20 - Driving range
- 21 - North wing rooms
- ▨ Not accessible

### South wing

Home to the largest number of bedrooms and both show venues, plus bars and the Travelling Duke Pub & Kitchen. There is a lift that serves all floors.

### Manor house

The centre-piece of the hotel, the original building that dates back hundreds of years. Only 16 bedrooms are located in this wing that also includes the Market Kitchen restaurant, Brasserie32 and many other lounges. There is no lift access to rooms in this wing.

### North wing

Accommodates a number of rooms in wings adjacent to the Manor House and not too far a walk from the Spa & Wellness Club, plus the T Golf & Activities. There are lifts in this wing but some rooms are stair-access only.

# HEYTHROP PARK

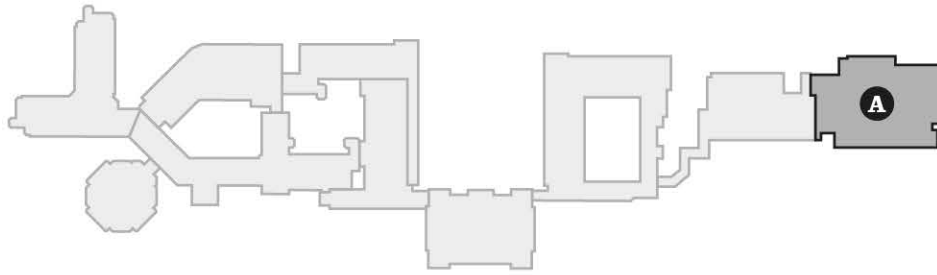

2

A - Spa & Wellness Club and treatment rooms

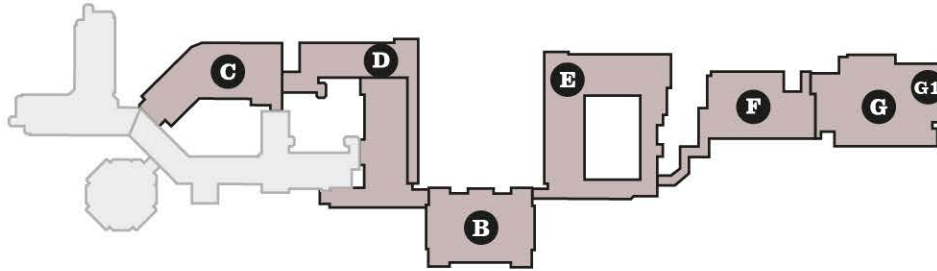

1

B - Manor house rooms 411-420  
 • Papillon bedroom  
 • Camilla bedroom  
 • Hampton bedroom  
 • Chai bedroom  
 • Longview bedroom  
 • Eldon bedroom  
 • Hydrangea bedroom  
 • Fern suite bedroom  
 • Tulip bedroom  
 • Berry bedroom

C - South wing rooms 301-327

D - Manor house rooms 531-562

E - Manor house rooms 641-670

F - North wing rooms 721-734 (Available 2023)

G - Spa & Wellness Club

G1 - The T Golf & Activities

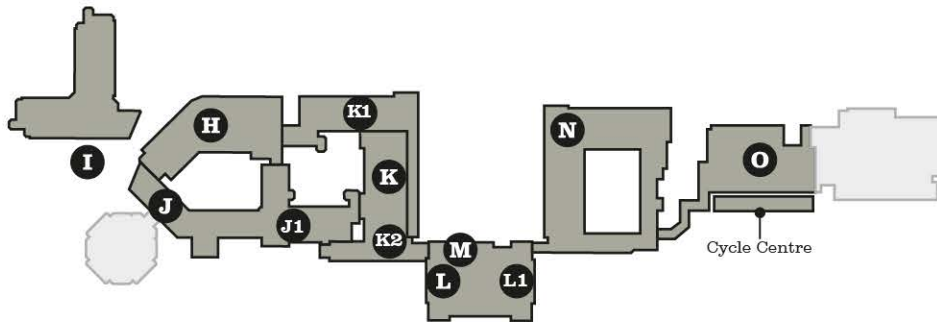

G

H - South wing rooms 253-279

I - South wing rooms 215-252

J - South wing rooms 201-214

J1 - Brassey Bar

K - Market Kitchen in the Orangery

K2 - Orangery lounge

K1 - Manor house rooms 501-527

L1 - Manor house lounges

L - Brasserie32 in the Manor house

M - Manor house reception and guest services

N - Manor house rooms 601-633

O - North wing rooms 701-712 (Available 2023)

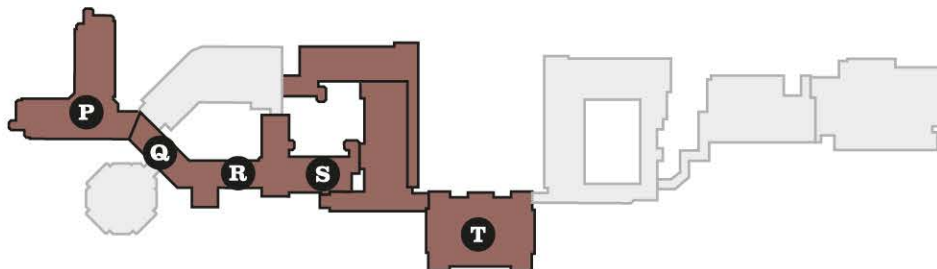

-1

P - South wing rooms 109-146

Q - South wing rooms 101-108

R - The Snug

S - The Travelling Duke Pub & Kitchen

T - Manor house rooms 401-406

• Garden bedroom

• Terrace bedroom

• Jasmine bedroom

• Cedar bedroom

• Juniper bedroom

• Magnolia bedroom

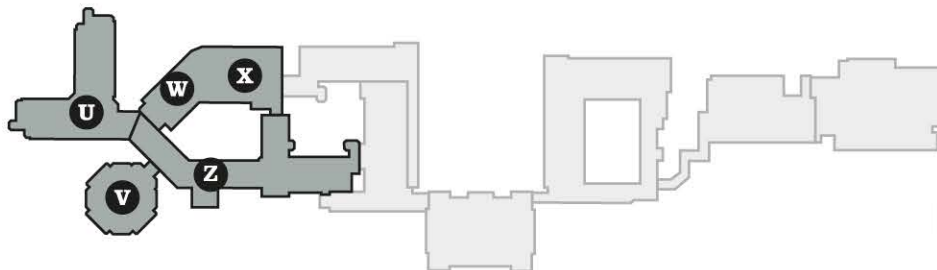

-2

U - South wing rooms 10-46

V - The Theatre

W - Late Lounge bar

X - Late Lounge

Z - South wing reception and guest services (and box office)

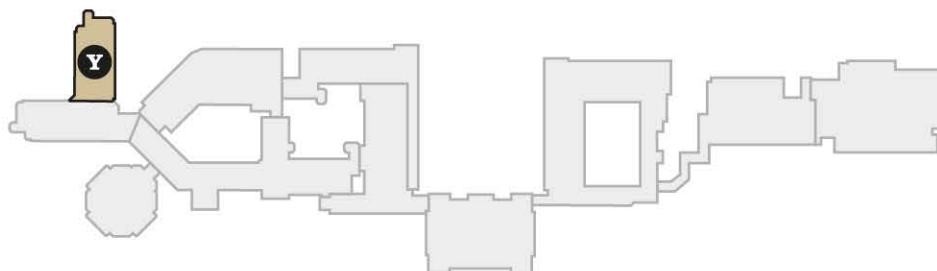

-3

Y - South wing rooms 1-9